

**D2 - 75**

A hot water heater may be connected to this engine by taking water from the existing hose between the turbocharger and the engine oil cooler outlet.

- 1 outlet to hot water circuit
- 2 return from hot water circuit

Replace the hose between the turbocharger and the oil cooler outlet.

Install the auxiliary hot water circuit so that its highest point is at least 50 mm (2") lower than the fluid level in the expansion tank. If this is not possible, a separate expansion tank must be installed.

If an external expansion tank is connected, the upper fluid level in the heat exchanger may not be higher than the MIN mark on the expansion tank.

**NOTICE!** No valves or thermostats are permitted in the extended water circuit as they can cause engine overheating.

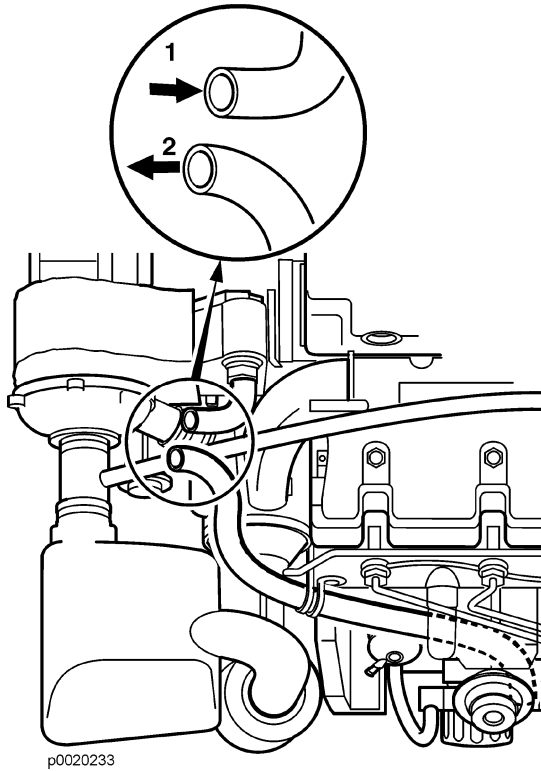

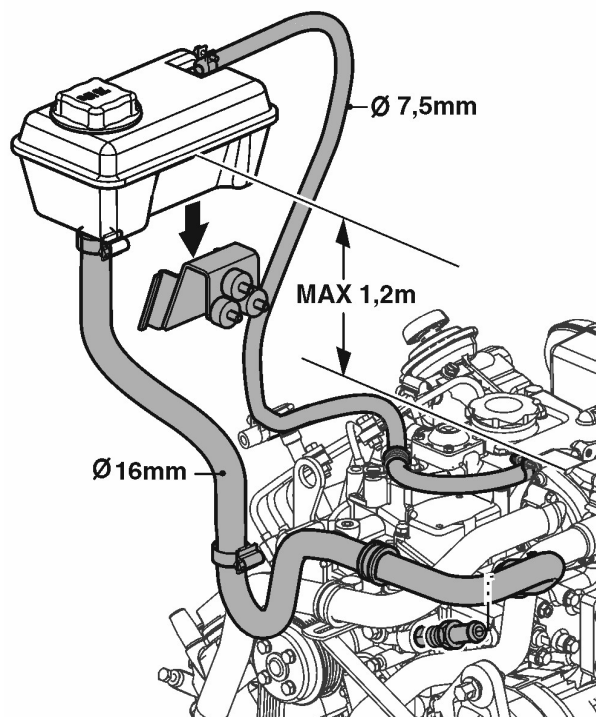

p0020232

## Extra expansion tank

### Freshwater system, auxiliary circuit

D1-13/20/30, D2-40 engines

If an auxiliary coolant circuit for e.g. hot water to heaters, demisters etc. must be connected, the engine freshwater system will require a greater volume of water, i.e. an auxiliary expansion tank in the system.

Maximum height between the highest point on the engine and the expansion tank fluid level is 1.2 meters.

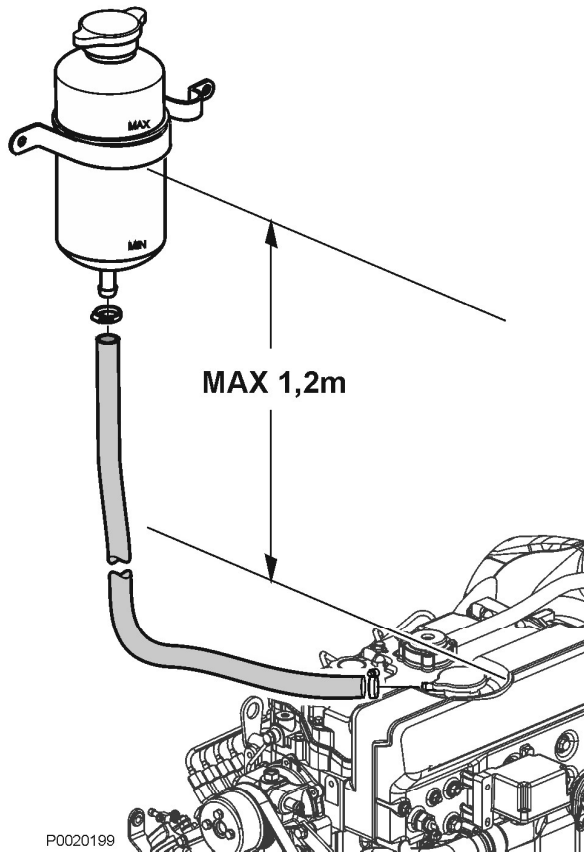

## D2-55/75

The engine expansion tank must have a separate venting line to the auxiliary tank connected below the MIN level.

The auxiliary expansion tank must be located so that it is easily accessible for level checks and filling.

Maximum height between the highest point on the engine and the expansion tank fluid level is 1.2 meters.

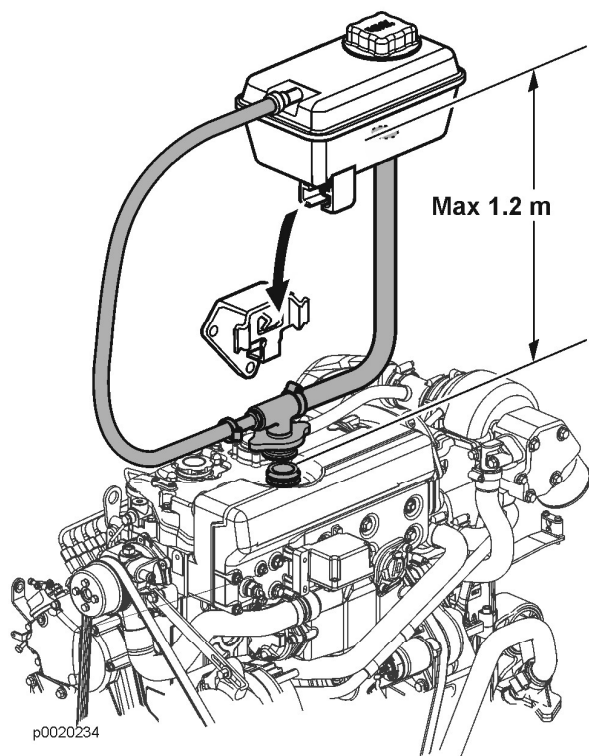

#### D2-55/75

The engine pressure cap must be replaced with a sealed cap. The regular engine venting hose from the thermostat housing may be connected to the auxiliary expansion tank below the **MIN** level to facilitate venting when coolant is filled.

The auxiliary expansion tank must be located so that it is easily accessible for level checks and filling.

Maximum height between the highest point on the engine and the expansion tank fluid level is 1.2 meters.